

1.21 BRC-A0/LA, BRD-A0/LA

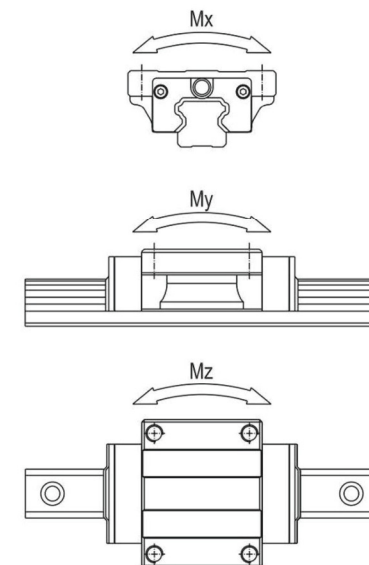
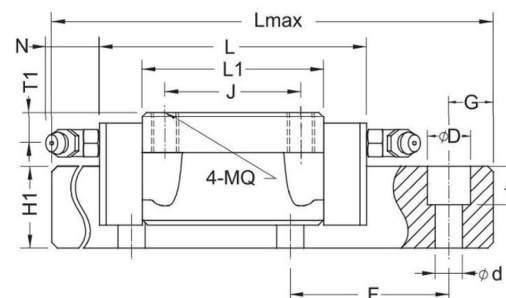
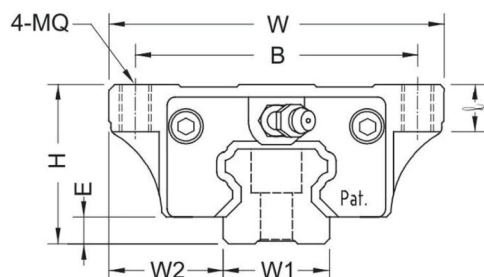
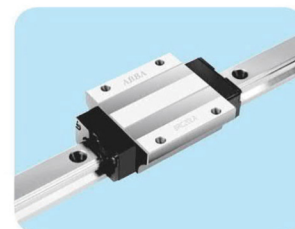
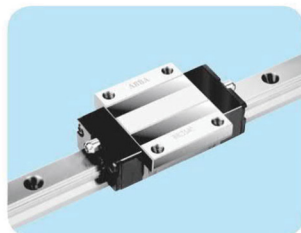

Model No.	Assembly (mm)				BR block (mm)							BR rail (mm)			
	H	W	W2	E	L	BxJ	MQxI	L1	Oil hole	T1	(N)	W1	H1	F	dxDxh
BRC15A0	24	47	16	4.6	66	38x30	M5x8	40	ø 3	4.3	5	15	14	60	4.5x7.5x5.8
BRD15A0					56										
BRC20A0	30	63	21.5	5	77.8	53x40	M6x9	48.8	M6x1	7	15.6	20	18	60	6x9.5x9.0
BRD20A0					67.8										
BRC20LA					92.4										
BRD20LA					82.4										
BRC25A0	36	70	23.5	7	88	57x45	M8x12	57	M6x1	7.8	15.6	23	22	60	7x11x9.5
BRD25A0					78										
BRC25LA					110.1										
BRD25LA					100.1										
BRC30A0	42	90	31	9	109	72x52	M10x12	72	M6x1	7	15.6	28	26	80	9x14x12.5
BRD30A0					99										
BRC30LA					131.3										
BRD30LA					121.3										
BRD35A0	48	100	33	9.5	109	82x62	M10x13	80	M6x1	8	15.6	34	29	80	9x14x12.5
BRD35LA					134.8			105.8							
BRD45A0	60	120	37.5	14	138.2	100x80	M12x15	105	M8x1	8.5	16	45	38	105	14x20x17.5
BRD45LA					163			129.8							

Model No.	Ref.Data (mm)		Basic Load Rating (Kgf)		Static Moment (Kgf·m)			Weight	
	Lmax	G	(C)	(Co)	Mx	My	Mz	Block(Kg)	Rail(Kg/m)
BRC15A0	4000	20	850	1350	10.1	6.8	6.8	0.21	1.4
BRD15A0									
BRC20A0	4000	20	1400	2400	24	14.6	14.6	0.4	2.6
BRD20A0									
BRC20LA			1650	3000	30	23.8	23.8	0.52	2.6
BRD20LA									
BRC25A0	4000	20	1950	3200	36.8	22.8	22.8	0.57	3.6
BRD25A0									
BRC25LA			2600	4600	52.9	45.5	45.5	0.72	3.6
BRD25LA									
BRC30A0	4000	20	2850	4800	67.2	43.2	43.2	1.1	5.2
BRD30A0									
BRC30LA			3600	6400	89.6	75.4	75.4	1.4	5.2
BRD30LA									
BRD35A0	4000	20	3850	6200	105.4	62	62	1.6	7.2
BRD35LA			4800	8300	141.1	109.8	109.8	2	
BRD45A0	4000	22.5	6500	10500	236.3	137.8	137.8	2.7	12.3
BRD45LA			7700	13000	292.5	210.9	210.9	3.6	

Note: BR35 and BR45 are not equipped with self-lubricant parts.